



Document reference ID : 2628

Licensing Application Summary

Application ID:	2628
Applicant Name:	Buzzed Beetle Brewery Llc
License Type applied for:	Brewery Retail License (BRL) (AS 04.09.320)
Application Status:	In Review
Application Submitted On:	03/06/2024 03:50 PM

Entity Information

Business Structure:	Limited liability company
FEIN/SSN Number:	991257727
Member Managed or Manager Managed:	Member Managed
Alaska Entity Number (CBPL):	10259199
Alaska Entity Formed Date:	01/05/2024
Home State:	AK

Entity Contact Information

Entity Address:	PO Box 210066, Anchorage, AK, 99521, USA
------------------------	--

Initial Application Information

Authority Type:	I am authorized user by the designated licensee with binding authority
------------------------	--

Legal First Name: Simone
Legal Last Name: Lange Teigen
Email Address: buzzedbeetlebrewery@gmail.com
Phone Number: 907-337-5338

Registered Agent Information

Name Simone Lange Teigen
Agent's Phone Number 907-891-9744
Agent's Email buzzedbeetlebrewery@gmail.com
Address PO Box 210066, Anchorage, AK, 99521, USA
The registered agent is either an individual resident of the state or a domestic corporation authorized to transact business in the state and whose business office is the same as the registered office? Yes

Ownership / Principal Party Details

Principal Parent Entity	Principal Party	Role	%Ownership
Buzzed Beetle Brewery Llc	Simone Lange Teigen	Member	100

Premises Address

Address: 3024 Mountain View Dr Suite 106, Anchorage, AK, 99501-3141, USA
Mailing Address: PO Box 210066, Anchorage, AK, 99521, USA
Does the proposed site include a valid street address? Yes

Primary license number

Primary License Information

Application ID - 2441 - New Brewery
Manufacturer License Application - In Review

I have read AS 04.09.050. The annual production of the Manufacturer license this retail license attaches to falls under:

04.09.050(a)

Basic Business information

Business/Trade Name:

3024 Mt. View Dr Suite 106

What is your primary business at this location?

Manufacturer

Premises Contact Details

Contact Person Name

Simone Lange Teigen

Business Phone Number

907-337-5338

Email Address

buzzedbeetlebrewery@gmail.com

Address:

PO Box 210066, Anchorage, AK, 99521, USA

Local Government and Community Council Details

City/Municipality

Anchorage (Municipality of)

Community Council Name

Mountain View

Property Ownership

Do you, the applicant, own the land, building, and/or warehouse at this proposed licensed location?

No

Property Utilization Status

An Existing Facility

Are you operating under?

Lease

Add Copy of Lease\Sublease document

[lease intent to rent to BBB 2024.pdf](#)

Premises Diagram

Will the license or permit embrace the entire premises address? Yes

Premises Diagram

- [Buzzed Beetle Brewery Layout.jpg](#)
- [arial view of mall BBB.jpg](#)

Security Plan

- [Patio Buzzed Beetle.pdf](#)

Financial Interest

I hereby certify that no person other than a proposed licensee listed on the liquor license application has a direct or indirect financial interest, as defined in AS 04.11.450(f) in the business for which a liquor license is being applied for.

I hereby certify that any ownership change shall be reported to the board as required under AS 04.11.040, AS 04.11.045, AS 04.11.050, and AS 04.11.055.

Public Notice Posting Attestation and Publishers Affidavit

Have you posted your application at both required locations for ten consecutive days? Yes

Attestations

I certify that all proposed licensees (as defined in AS 04.11.260) and affiliates have been listed on this application.

I certify that I understand that providing a false statement on this form or any other form provided by AMCO is grounds for rejection or denial of this application or revocation of any license issued.

I certify that all licensees, agents, and employees who sell or serve alcoholic beverages or check the identification of a patron will complete an approved alcohol server education course, if required by AS 04.21.025, and, while selling or serving alcoholic beverages, will carry or have available to show a current course card or a photocopy of the card certifying completion of approved alcohol server education course, if required by 3 AAC 305.700.

I agree to provide all information required by the Alcoholic Beverage Control Board in support of this application.

I hereby certify that I am the person herein named and subscribing to this application and that I have read the complete application, and I know the full content thereof. I declare that all of the information contained herein, and evidence or other documents submitted are true and correct. I understand that any falsification or misrepresentation of any item or response in this application, or any attachment, or documents to support this application, is sufficient grounds for denying or revoking a license/permit. I further understand that it is a Class A misdemeanor under Alaska Statute 11.56.210 to falsify an application and commit the crime of unsworn falsification.

I certify that all proposed licensees have been listed with Division of Corporation, Business, and Professional Licensing.

I certify that I and any individual identified in the business entity ownership section of this application, has or will read AS 04 and its implementing regulations.

Signature

This application was digitally signed by : Simone Lange Teigen on 3/6/2024 3:47:25 PM

Payment Info

Payment Type : CC

Payment Id: 1fcc0c3f-b717-4e6a-b7f5-1e26031997fc

Receipt Number: 100780256

Payment Date: 3/6/2024 3:53:38 PM

Documents

#	File Name	Type	Added On
1	lease intent to rent to BBB 2024.pdf	License Lease\Sublease document	03/06/2024 06:41 AM
2	Buzzed Beetle Brewery Layout.jpg	License Location Diagram Document	03/06/2024 06:43 AM
3	arial view of mall BBB.jpg	License Location Diagram Document	03/06/2024 06:45 AM

The patio area for Buzzed Beetle Brewery, will be roped off with chains attached to 3-foot-high stands. This outside space will be utilized from May 1st to Sept 30th.

When the area is occupied a staff member will be present during the entire duration of occupancy. Identification will be checked to see who is of legal drinking age. If someone under the age of 21 is accompanied by a parent or spouse they will be able to enter the patio but they will be informed that they are not allowed to have access to alcoholic beverages and staff member will observe to make sure that they do not violate the underage drinking laws.

Each guest that is on the patio will be monitored to ensure that no underage drinking is being permitted. If such actions are observed, a cease and desist of said actions will be given to parties that are in violation of the underage drinking laws. An incident report will be filled out and kept on premises and any video footage that may contain said actions will be marked and saved and annotated on the incident report, that there is a video footage of violation.

Both parties will then be asked to leave the premises as they are in violation of the underage drinking law.

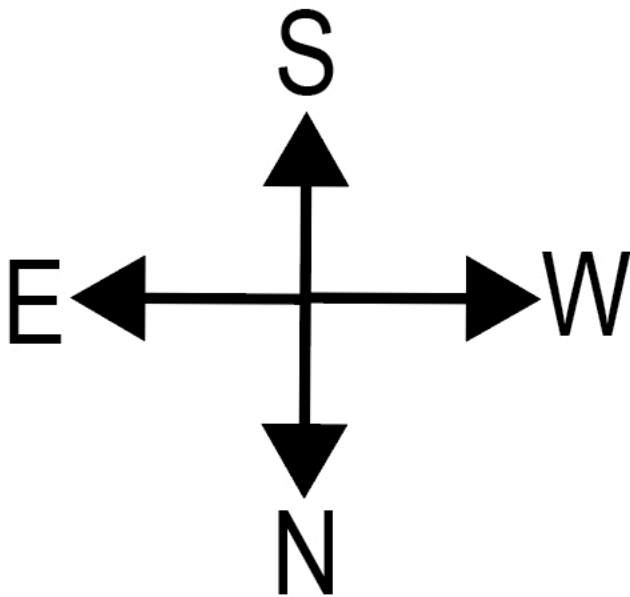

Dominos
Pizza

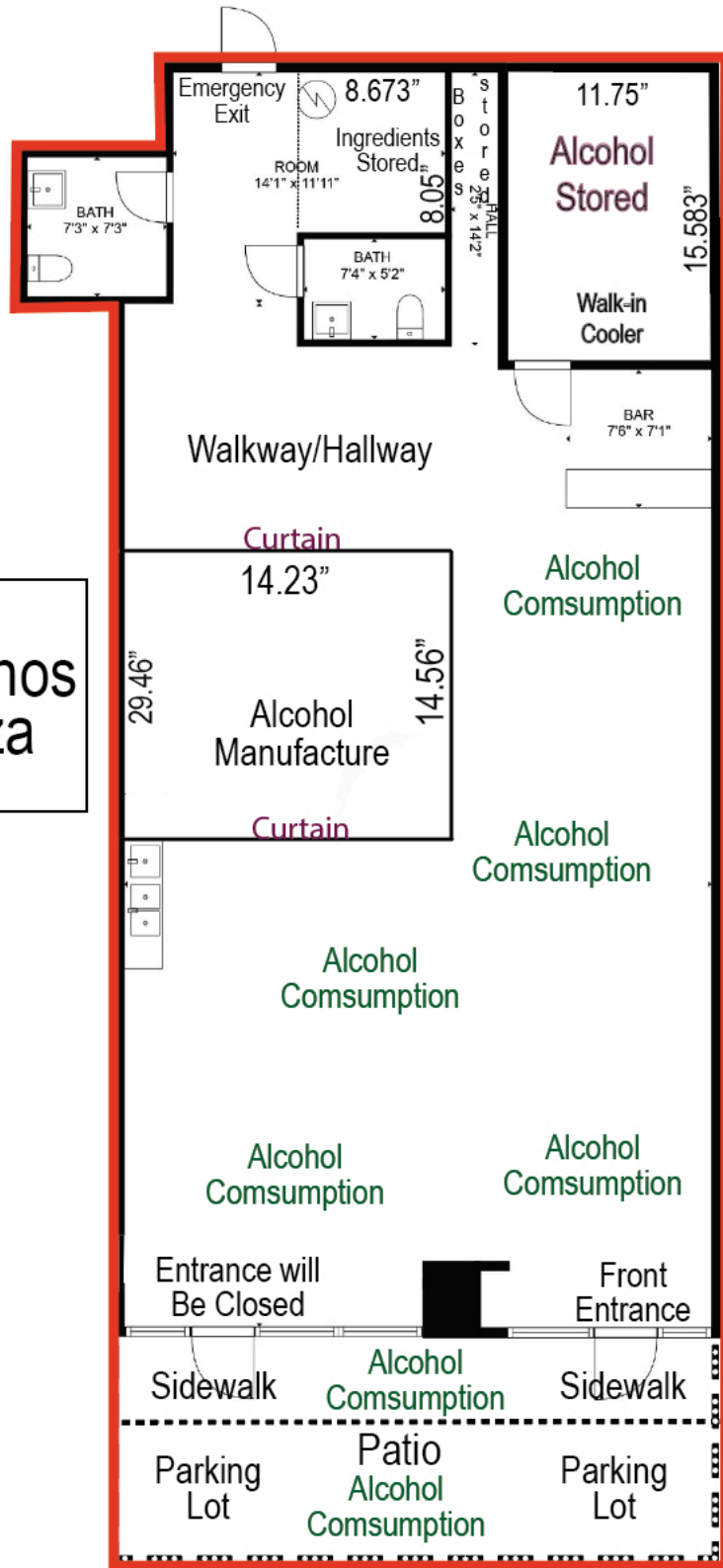

Frost
Dental

31.5"



Tempura Express
US Coast Recruiting
Cricker
Domino's Pizza
Buzzed Beetle Brewery
Frat Dental
Spinz Chicken

